

# THE COPPERFIELD



ELEVATION B



ELEVATION A (with Optional Partial Stone Front)



ELEVATION C



TRINITY  
H O M E S

2700 E. DUBLIN GRANVILLE ROAD, SUITE 300, COLUMBUS, OHIO 43231  
PH 614.898.7200 FAX 614.898.7210

[WWW.TRINITY-HOMES.COM](http://WWW.TRINITY-HOMES.COM)

# THE COPPERFIELD

## ILLUSTRATED PLAN OPTIONS

- 01 Family Room Transom Windows (3)
- 02 Fireplace Exterior Location
- 03 Direct Vent Fireplace
- 04 Optional Desk in Kitchen
- 05 4' Extension to Family Room
- 06 Living Room Decorative Columns (2)
- 07 Dining Decorative Columns (2)
- 08 Dining Room Coffered Ceiling
- 09 Laundry Tub
- 10 Service Door
- 11 Oak Rail in lieu of Half Wall
- 12 Deluxe Master Bath
- 13 Tray Ceiling in Master Bedroom (Elev. D only)
- 14 Vaulted Ceiling in Master Bath
- 15 Cathedral Ceiling in Master Bedroom
- 16 Cathedral Ceiling in Master Bedroom & Master Bath
- 17 Double Dormer
- 18 Optional Laundry Chute
- 19 Relocated Hall Bath
- 20 Additional Hall Bath Door

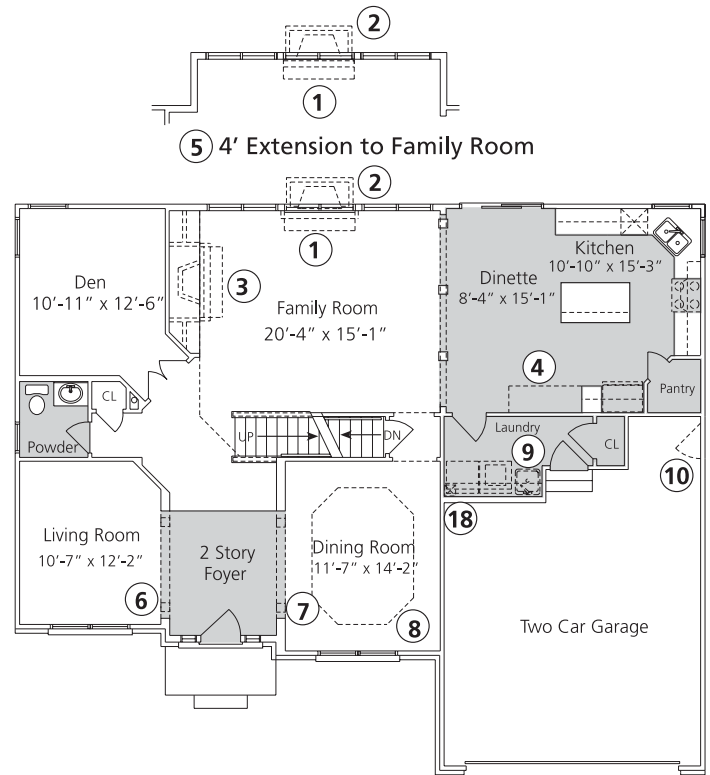

First Floor (Elevation "A")

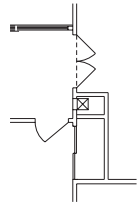

18 Optional Laundry Chute

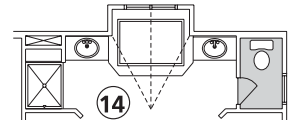

12 Deluxe Master Bath

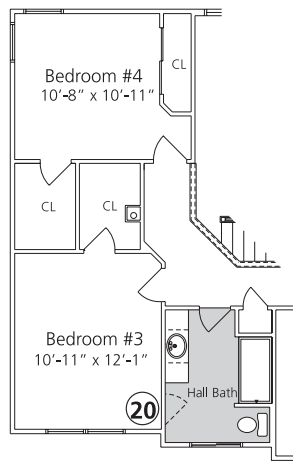

19 Relocated Hall Bath

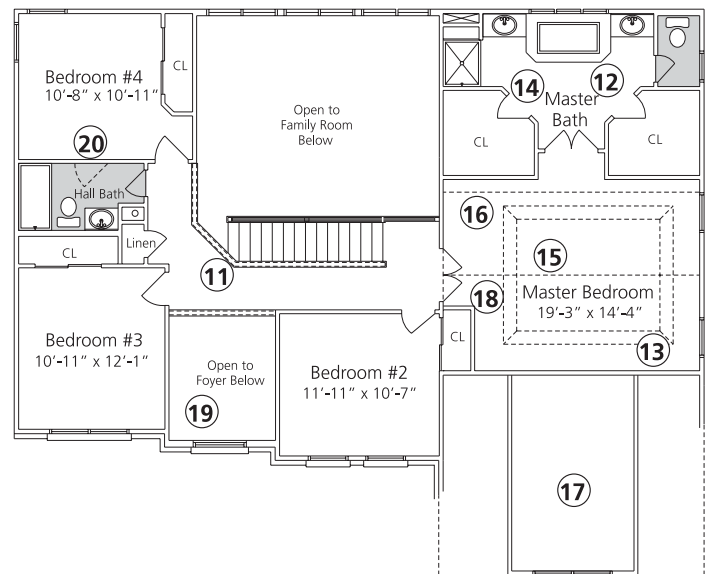

Second Floor (Elevation "A")

- Indicates Sloped Ceilings
- Shaded areas indicate hard floor surface

Additional options not illustrated are available, please request from Sales Consultant.



**TRINITY**  
H O M E S

WWW.TRINITY-HOMES.COM

Because we are constantly improving our product, we reserve the right to revise, change, and/or substitute product features, dimensions, specifications, architectural details and designs without notice. This brochure is for illustrative purposes only and is not part of a legal contract. Prices are subject to change without notice. Room dimensions are approximate, are rounded, they will vary with each elevation. The drawings and floor plans for the actual home as constructed are protected by U.S. Copyright Laws. They may not be copied, reproduced or otherwise used by others in any manner. A2696 Northlawn Construction Services 9/01/05



Broker Participation Welcome